



Porsche 997/987 Key Kit Instructions

Get in touch for any questions or support:

Email:
josh@bdpuk.co.uk
Instagram:
[@black_dog_projects](https://www.instagram.com/black_dog_projects)
Website:
www.bdpuk.co.uk

1.



Requirements

You need a working OEM key (internals), BDP key kit and a flat head screw driver

2.



Opening Old Key

Start by opening the lid of the OEM key from the key loop end

3.



Remove PCB Board

Once open, carefully remove the PCB board and battery assembly

4.

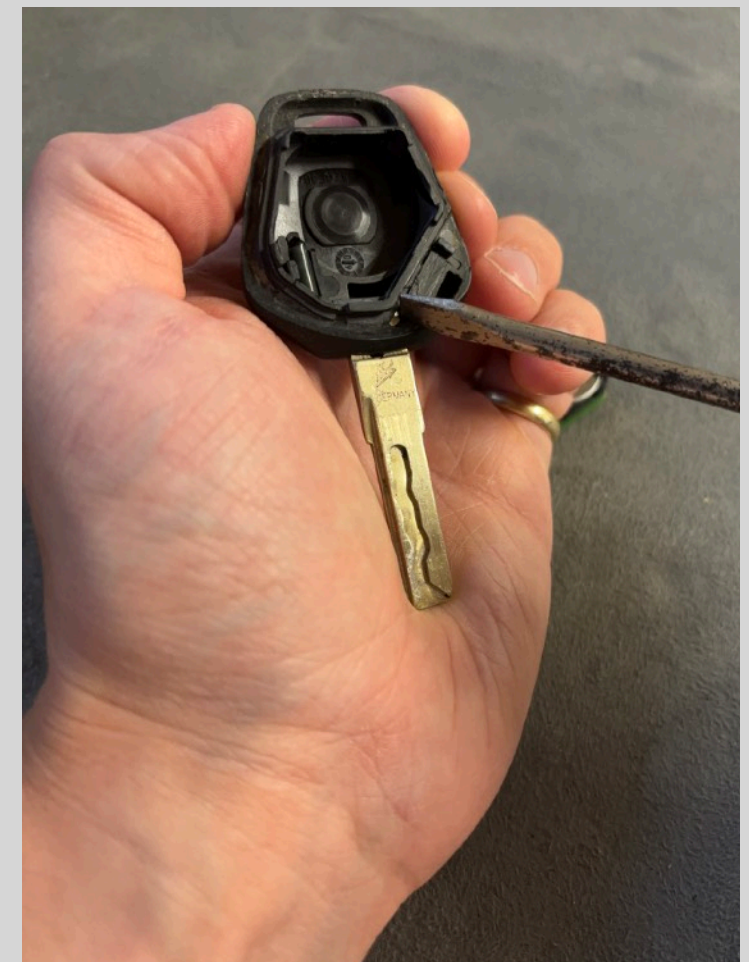

Remove Key Blade

Pull the slider back and draw the key blade from the housing

5.



Remove Pill

With the screw driver, carefully lift the pill from the recess. This part is fragile, handle with care

6.



New Key Case

Removing all packaging, your new key kit will come in 2 halves with BDP crest

7.



Insert Key Blade

Insert the key blade into the opening at the front of the key. Ensure the key is fitted all the way.

8.

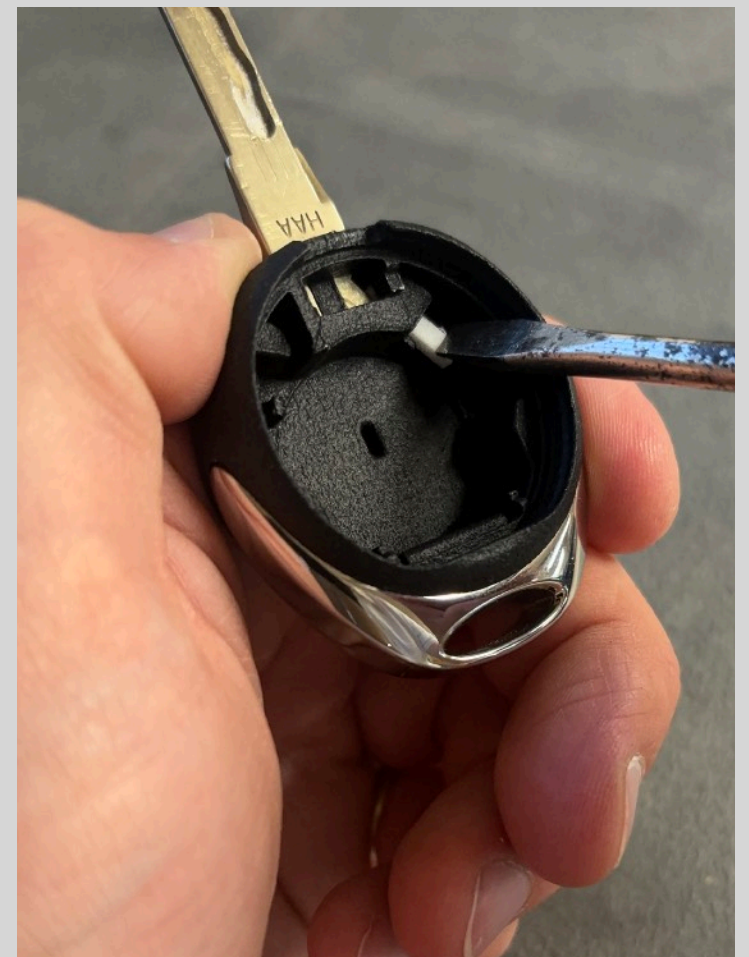

Lock Key

Using the screw driver, push the white pin towards the key blade, locking it in place

9.



Insert Pill

Place the pill (clear end towards the key) into the slot located to the left of the key blade

10.



Insert PCB

On the button side of case, clip the PCB button side down into the casing

11.



Fitting Lid

Press down to fit the two halves together, where they should 'snap' together

12.



Button Test

Test the buttons to ensure good contact with the PCB (not doughy) and the LED lights up

13.

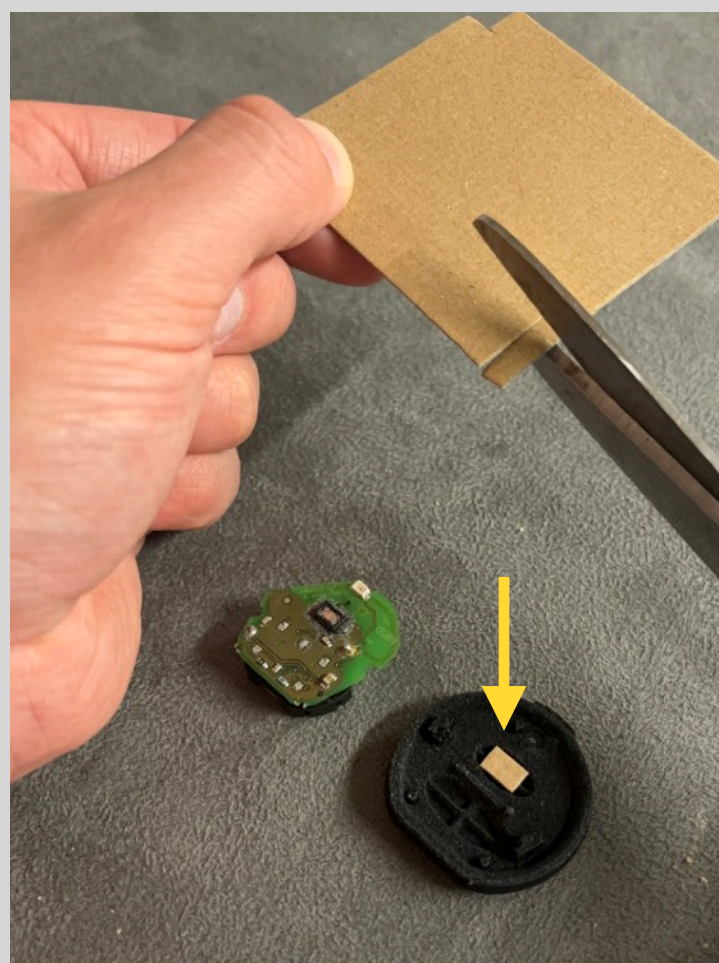

'Doughy' Buttons

Adding a thin layer of card to the back of the buttons can improve button contact

14.



Complete the Kit

Using a small dab of adhesive in the recess or 3M tape, fit your chosen crest.



OEM Key Badges available here:

Suncoast Parts [HERE](#)

Design911 [HERE](#)

Keep this instruction set for a 1 year warranty on plastic components.

Please remember to leave a review, or share to social media. Your support helps us grow and develop new projects!